

LEVEL 12 - LEISURE DECK

▲
GULF & PALM
JUMEIRAH VIEW

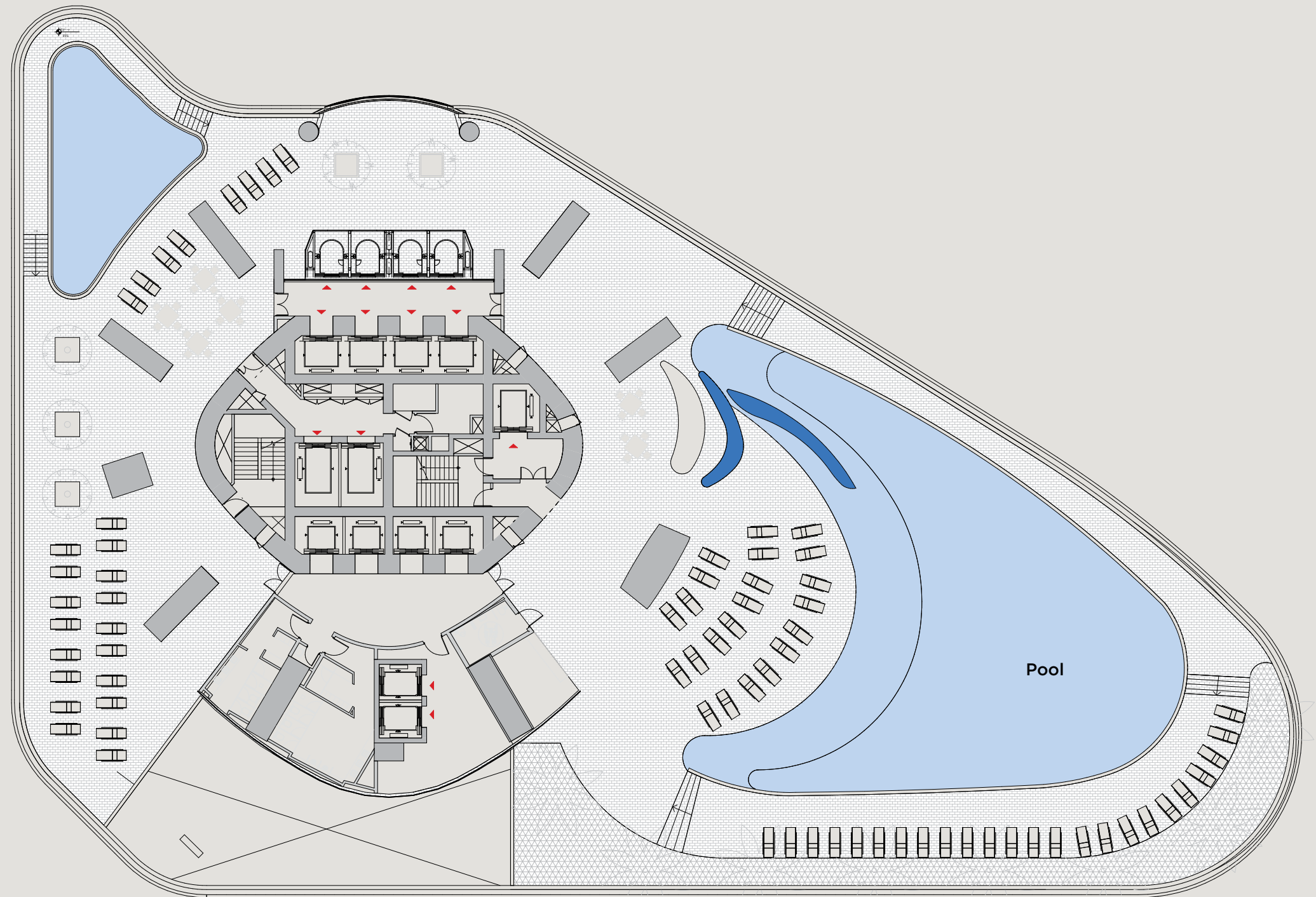

▼
DUBAI MARINA
VIEW

LEVEL 13 - ALL DAY DINING
LEVEL 14 - LUXURY DINING

GULF & PALM
JUMEIRAH VIEW

DUBAI MARINA
VIEW

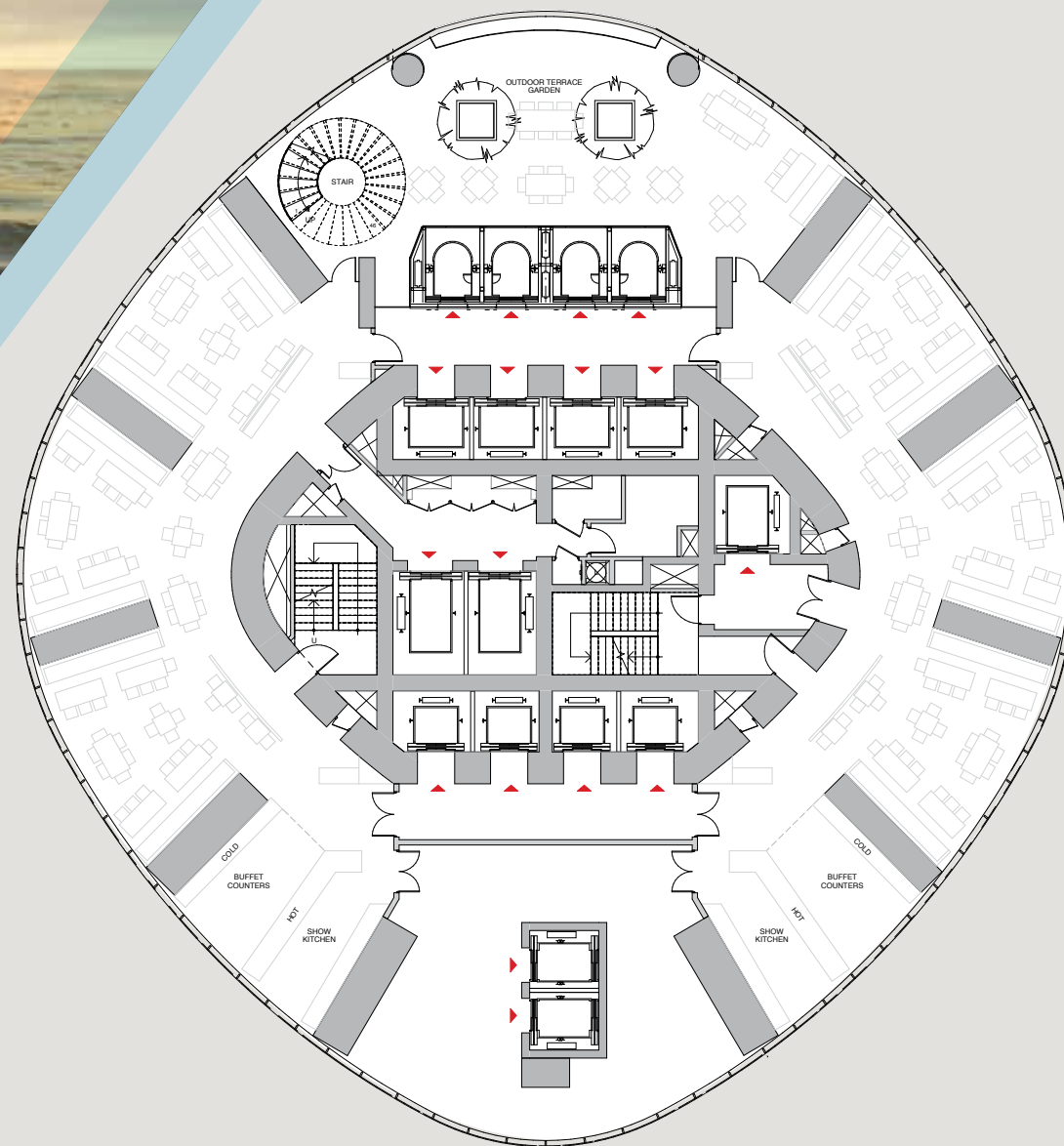

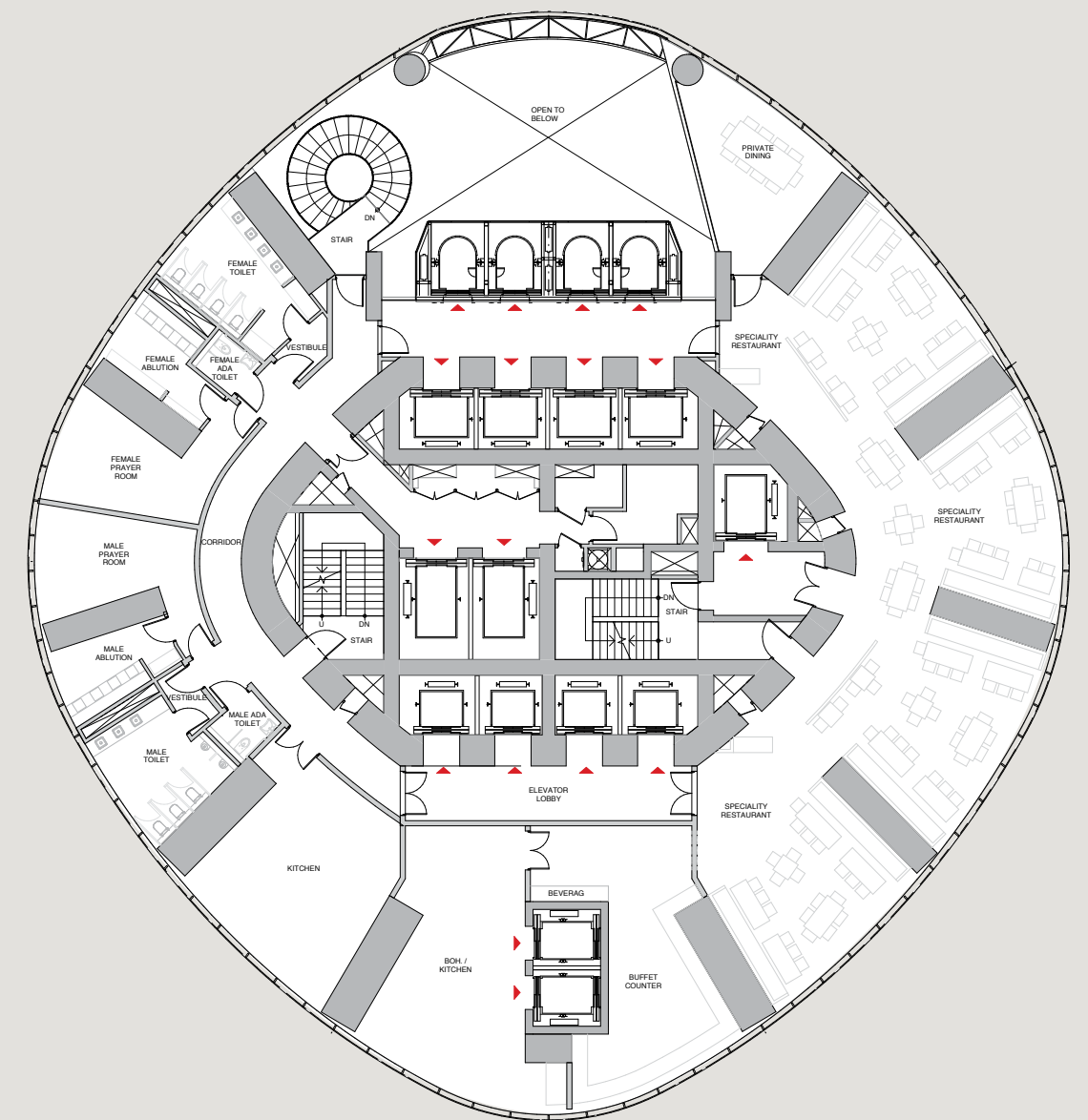

LEVEL 13

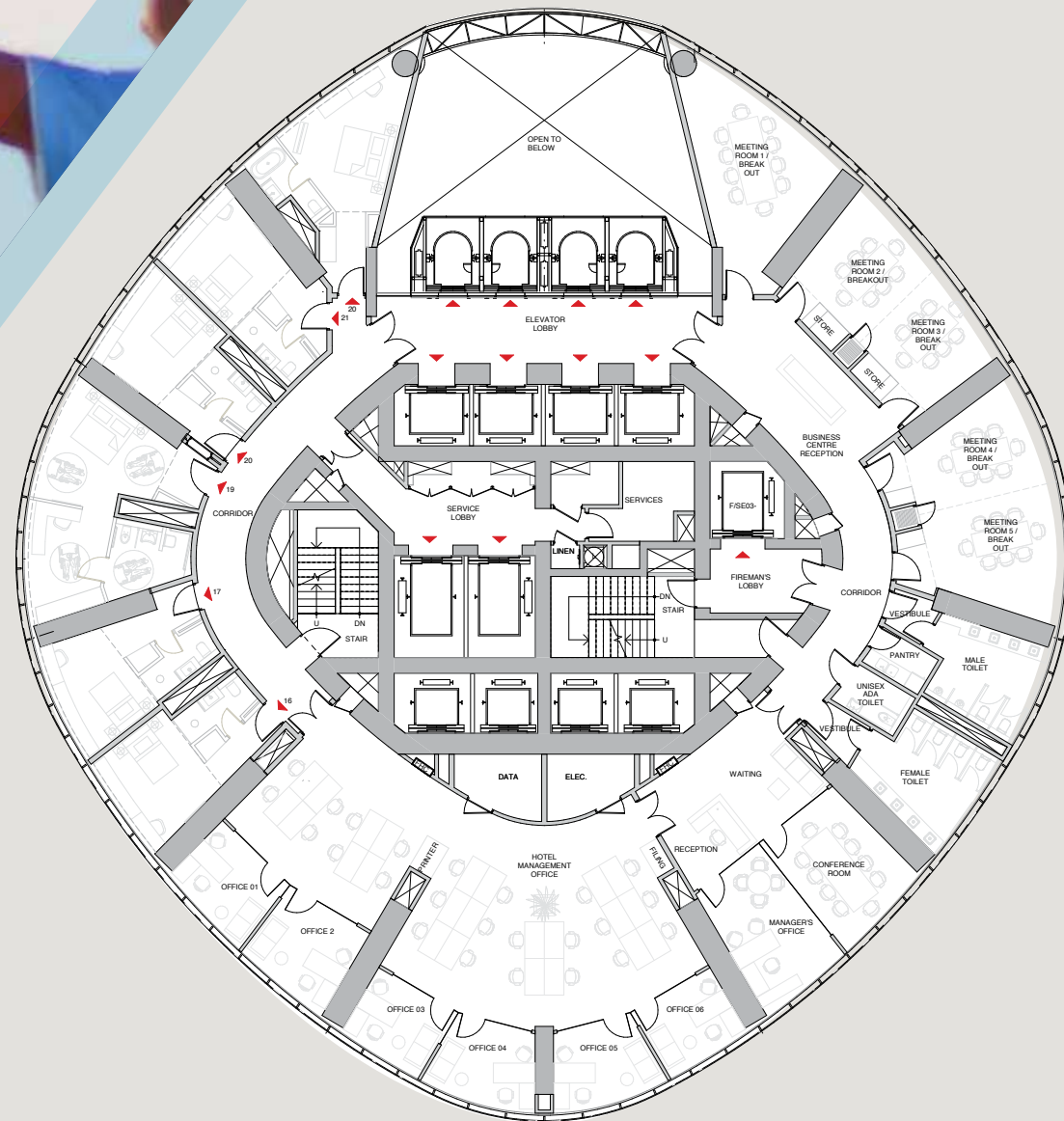

LEVEL 14

LEVELS 15 - HOTEL ROOMS & MEETING FACILITIES
 LEVEL 16 - 19 - HOTEL ROOMS



LEVEL 15

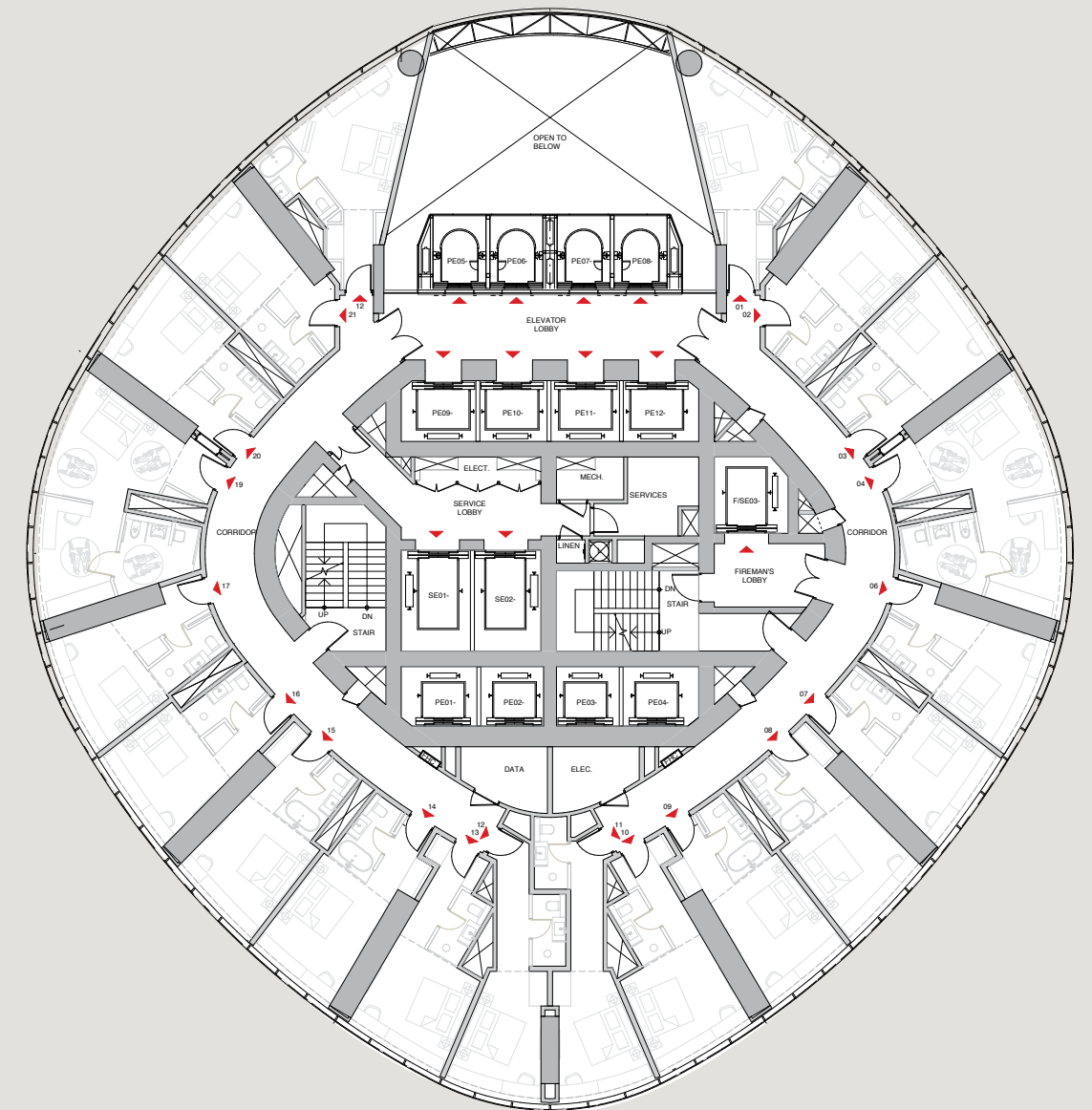

LEVELS 16 - 19

DUBAI MARINA
 VIEW



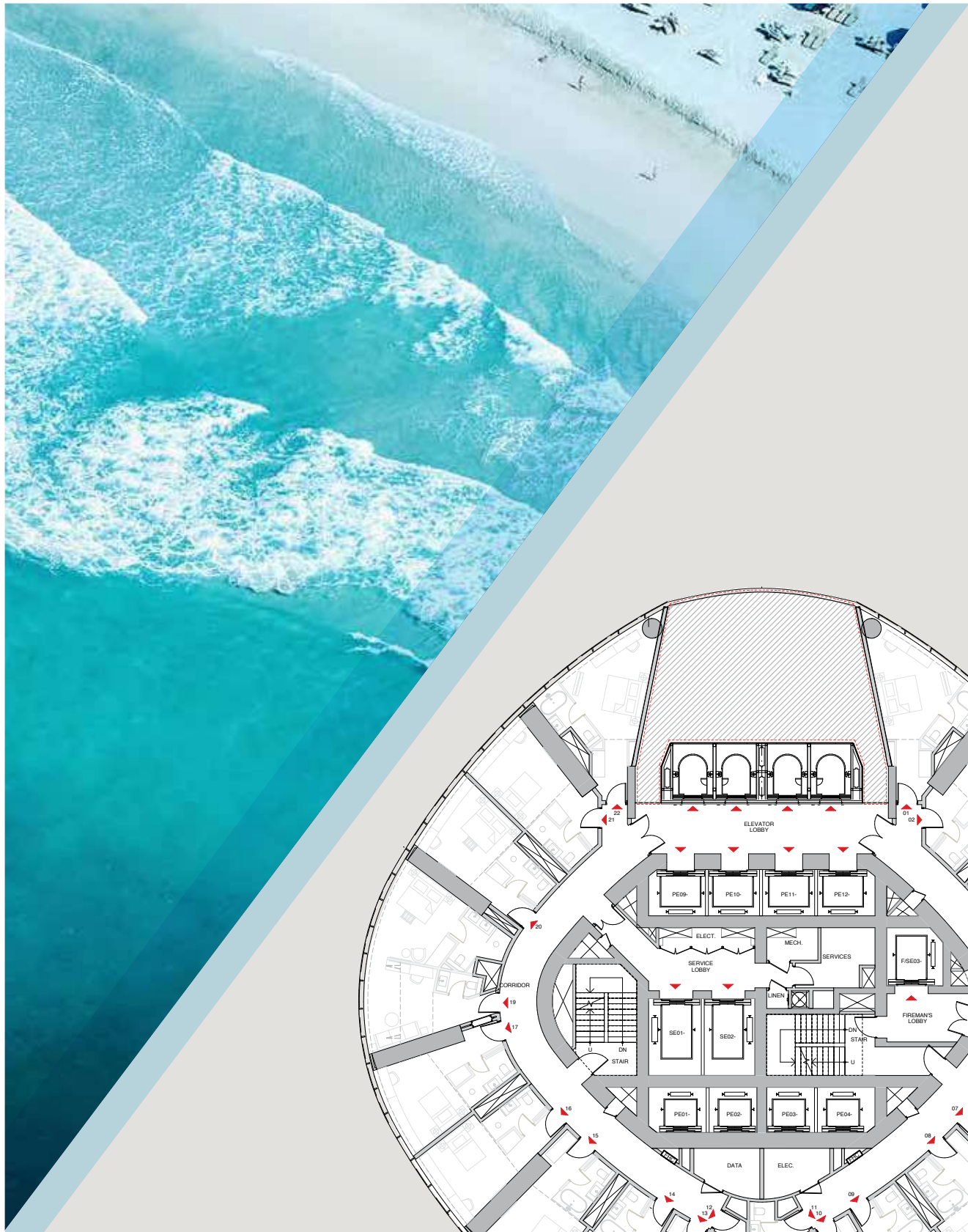

LEVELS 20, 22 - 39 - HOTEL ROOMS
LEVELS 40 - 53 - HOTEL ROOMS



GULF & PALM
JUMEIRAH VIEW

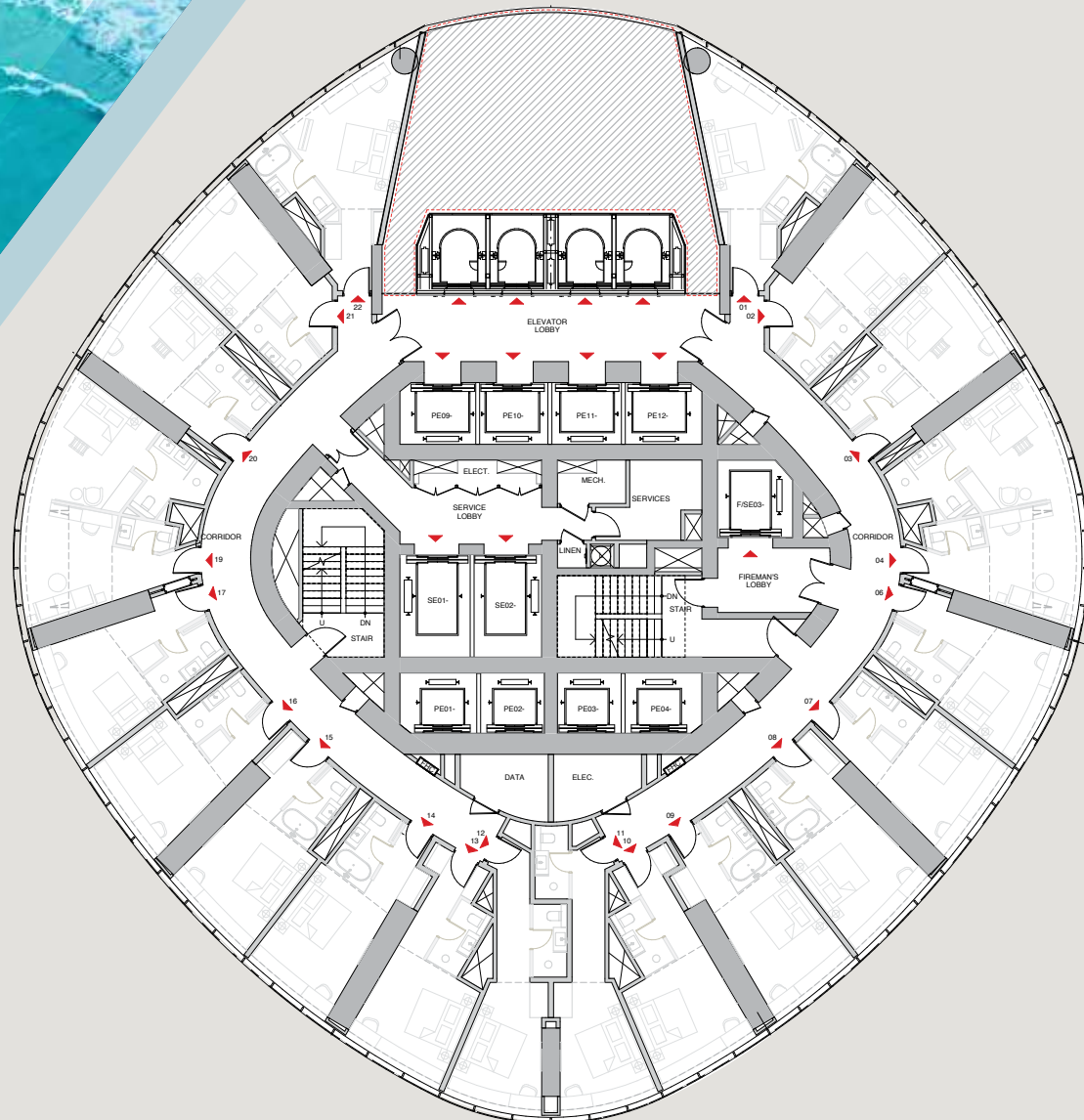

LEVELS 20, 22 - 39

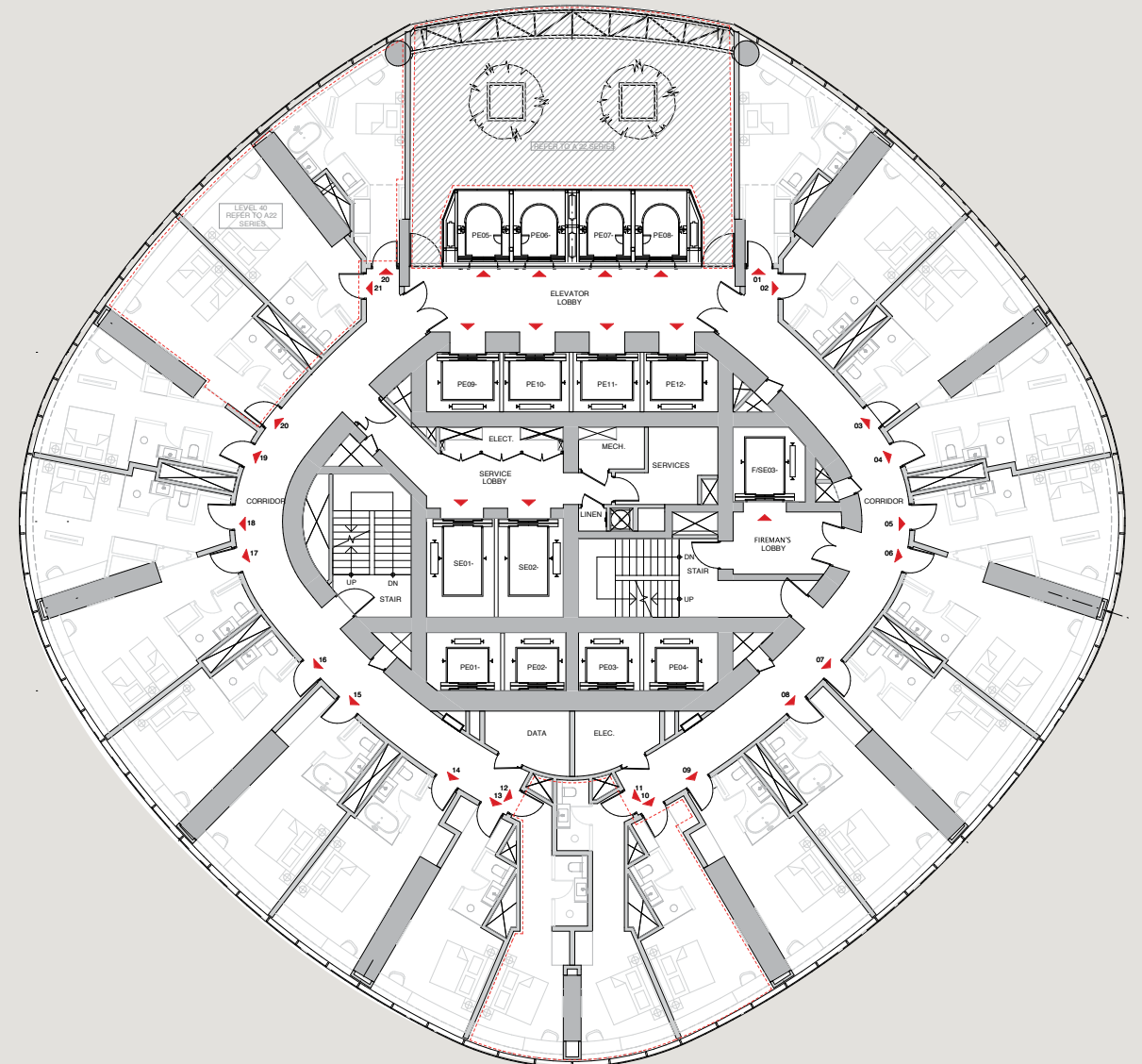

LEVELS 40 - 53

DUBAI MARINA
VIEW



LEVELS 55 - 68 - HOTEL ROOMS
 LEVELS 69 - 71 - HOTEL ROOMS

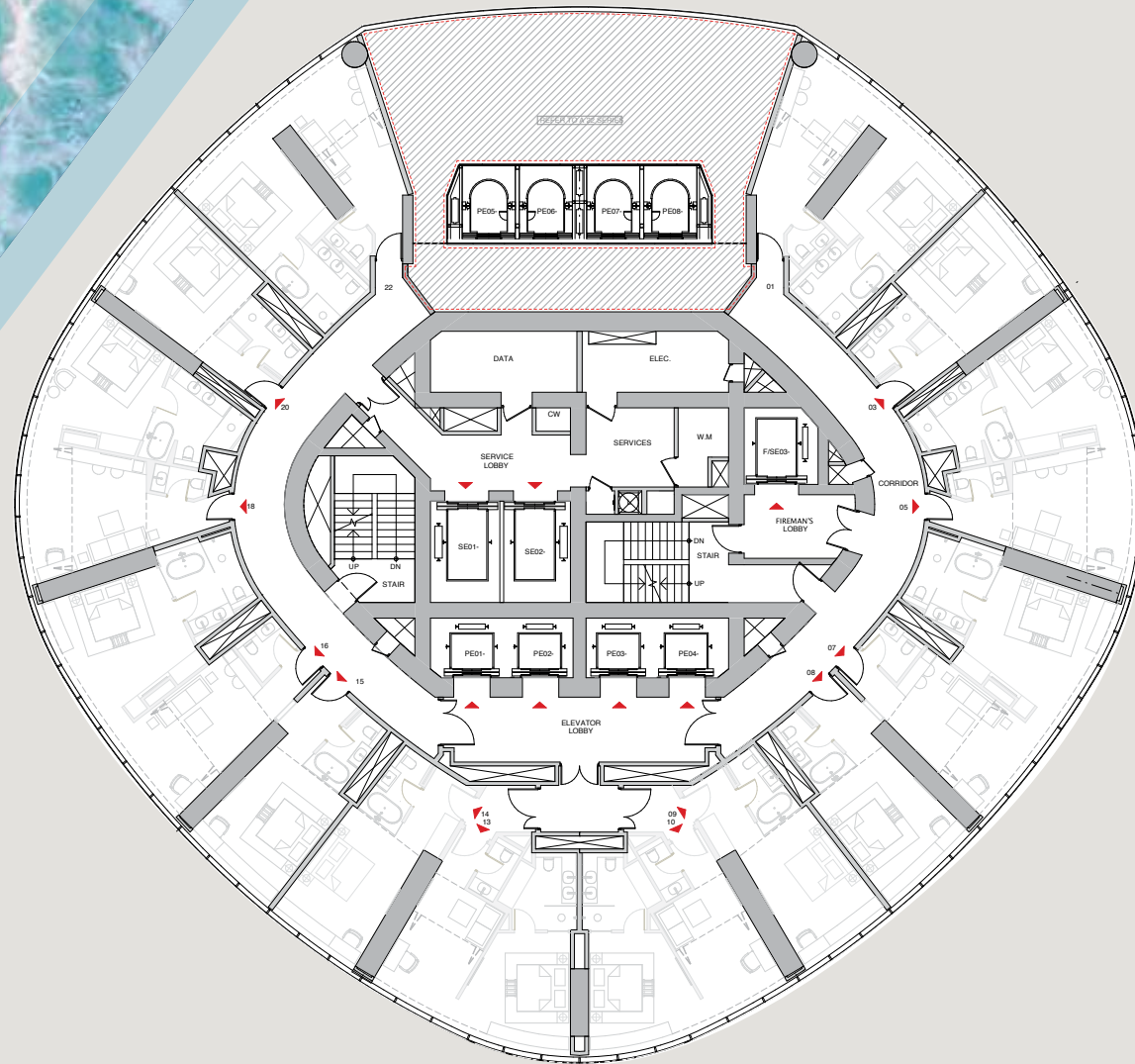

LEVELS 55 - 68

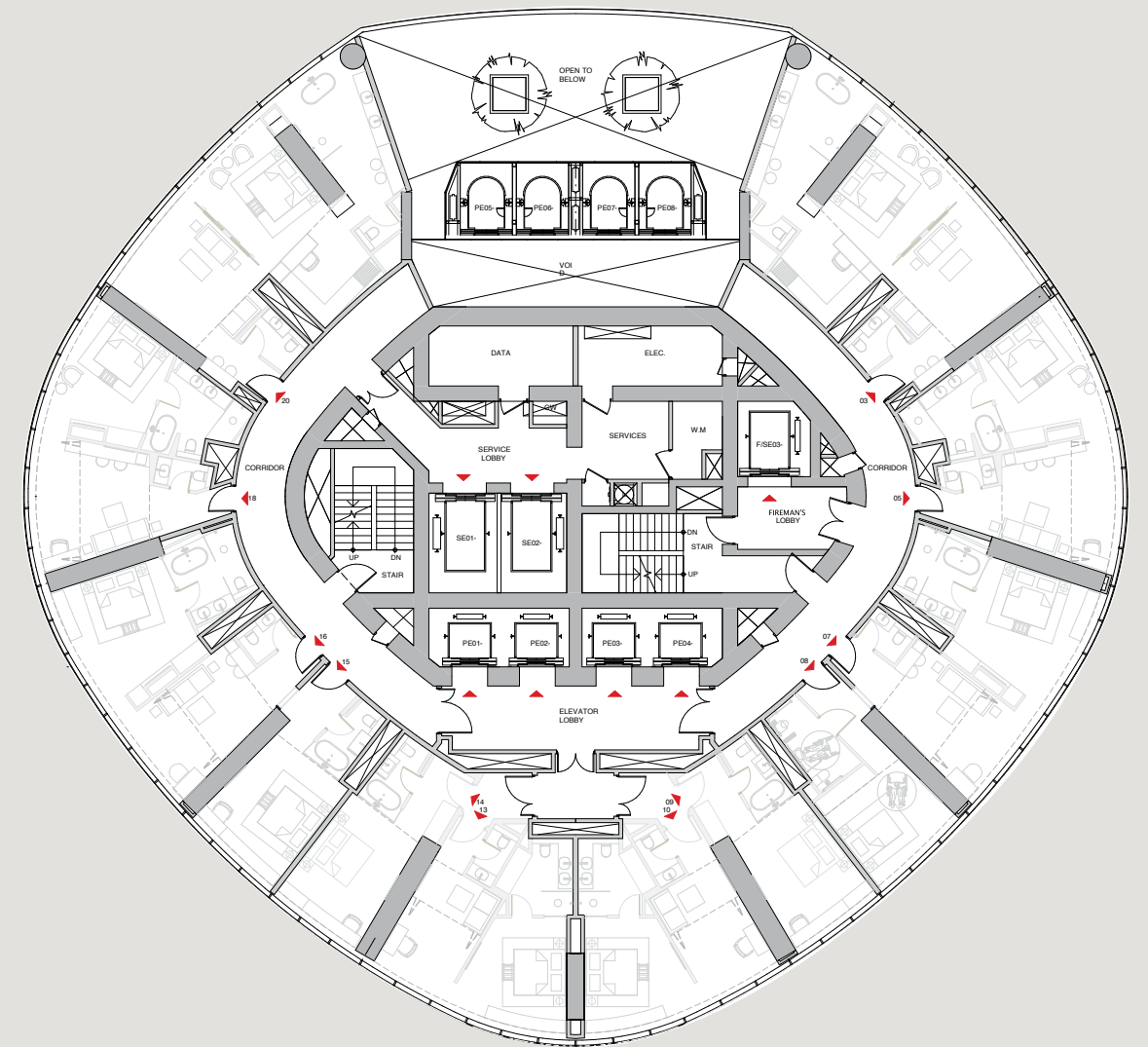

LEVELS 69 - 71

DUBAI MARINA
 VIEW





LEVEL 72 - HOTEL ROOMS



GULF & PALM
JUMEIRAH VIEW

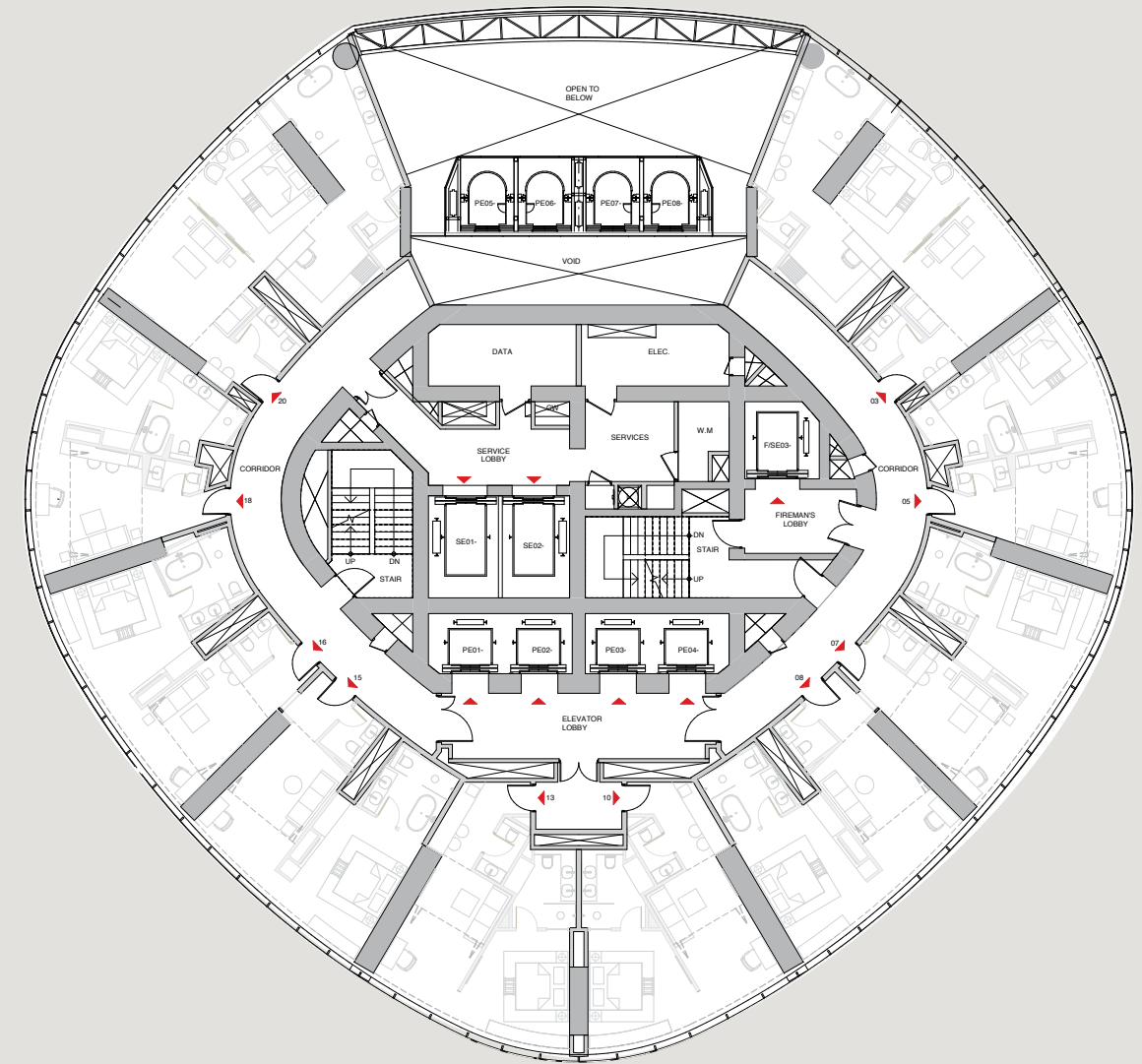

LEVEL 72

DUBAI MARINA
VIEW



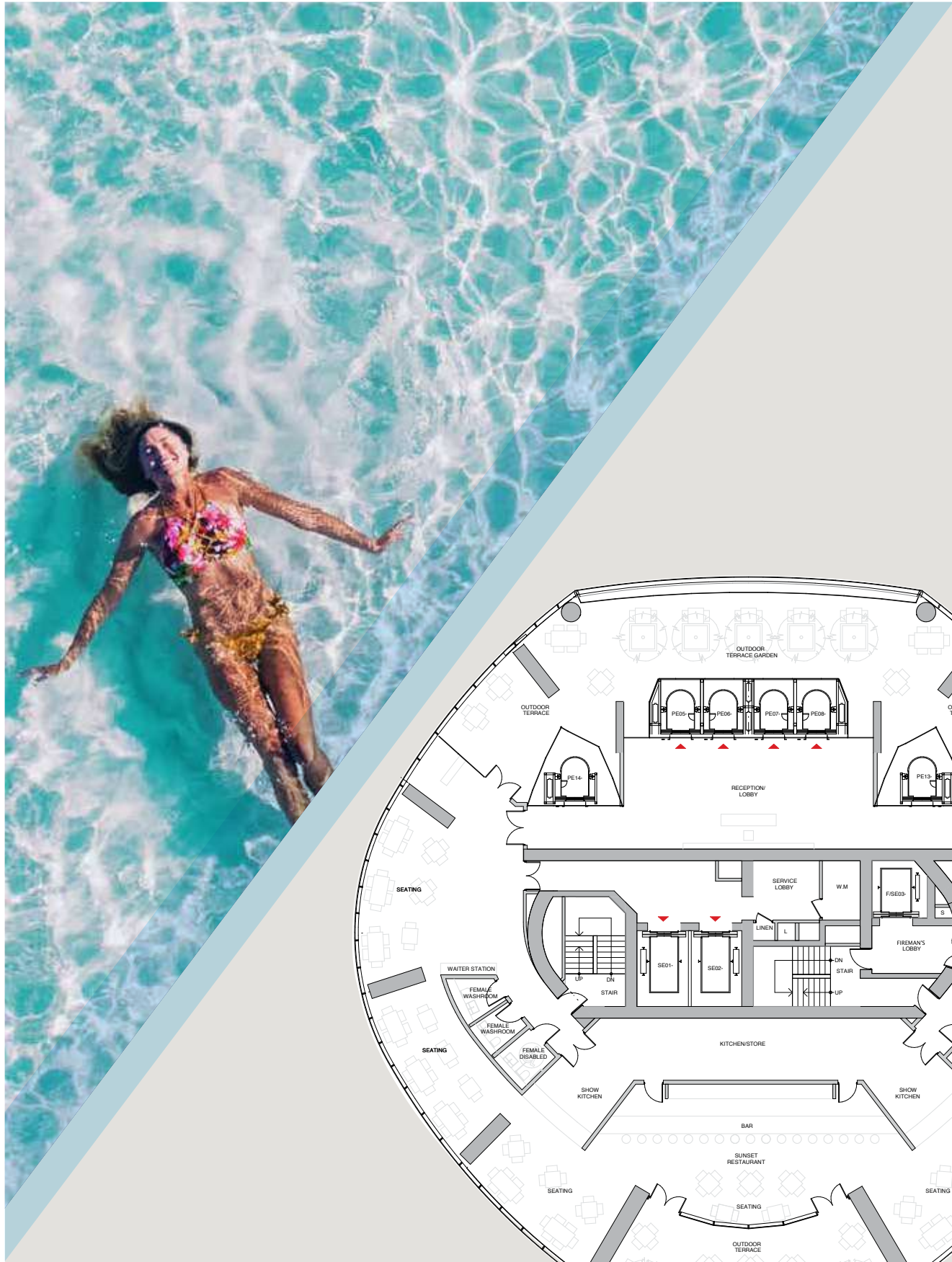

LEVEL 74 - SUNSET RESTAURANT
LEVEL 76 - HORIZON LOUNGE



GULF & PALM
JUMEIRAH VIEW

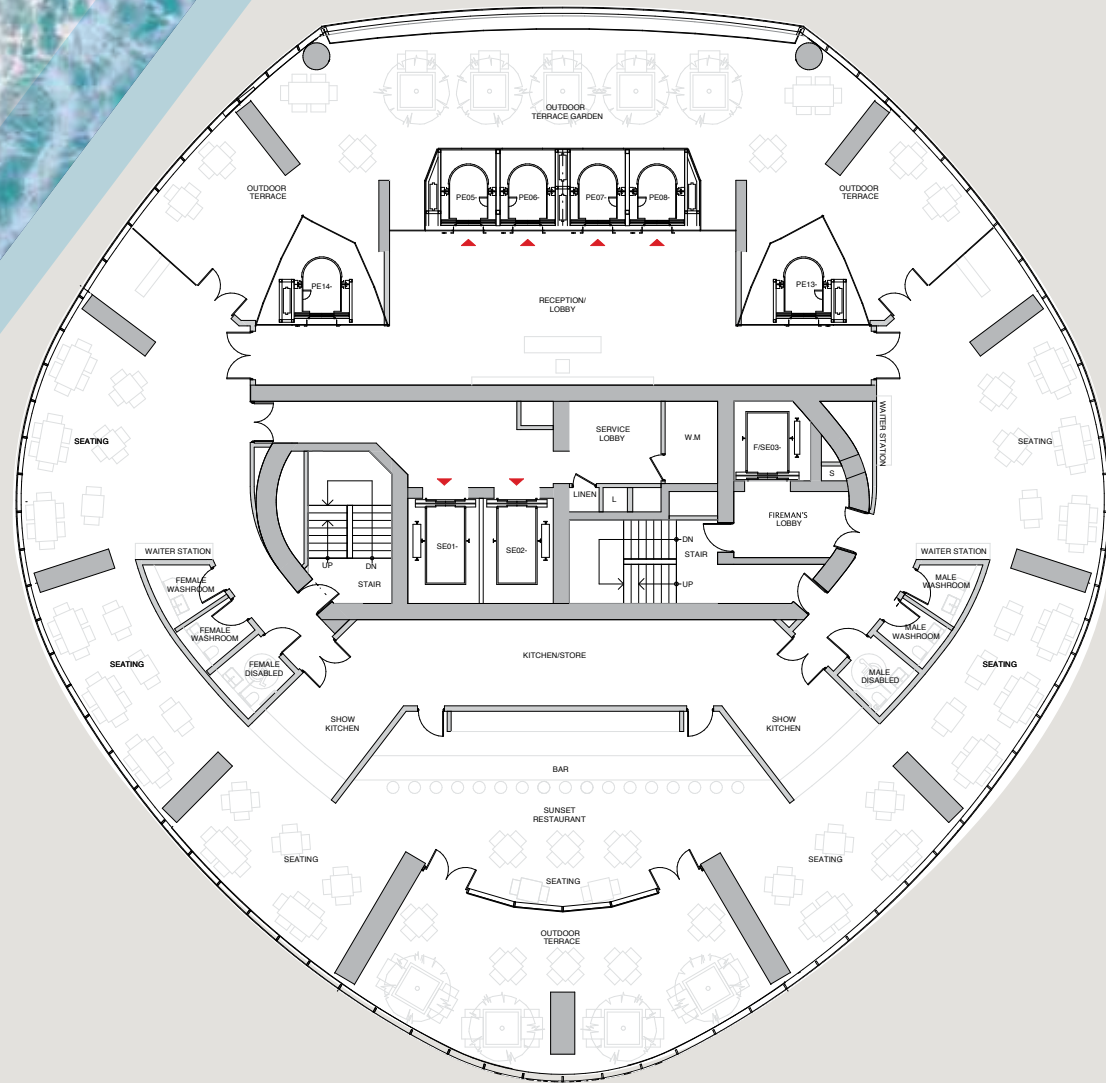

LEVEL 74

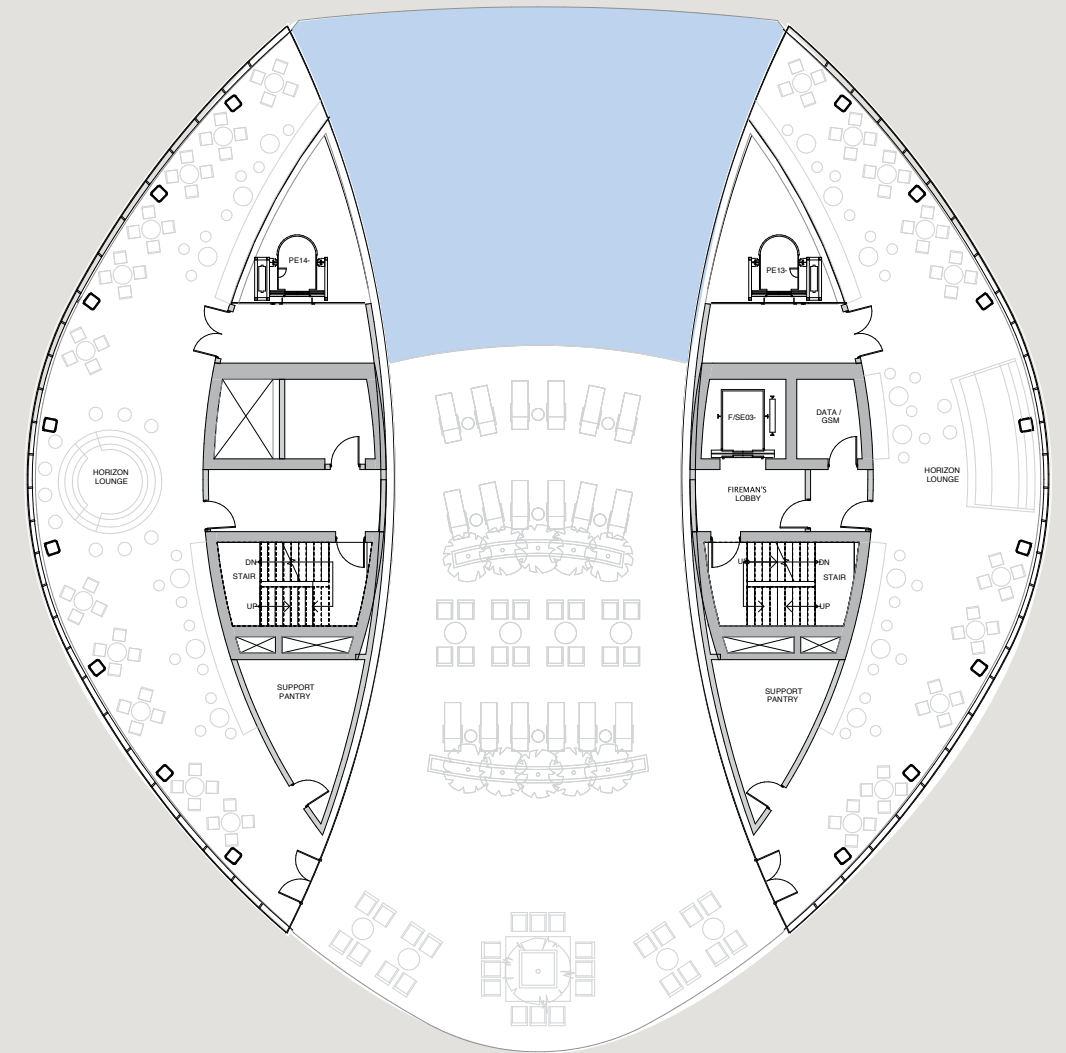

LEVEL 76

DUBAI MARINA
VIEW



LEVEL 77 - SKY TERRACE



GULF & PALM JUMEIRAH VIEW

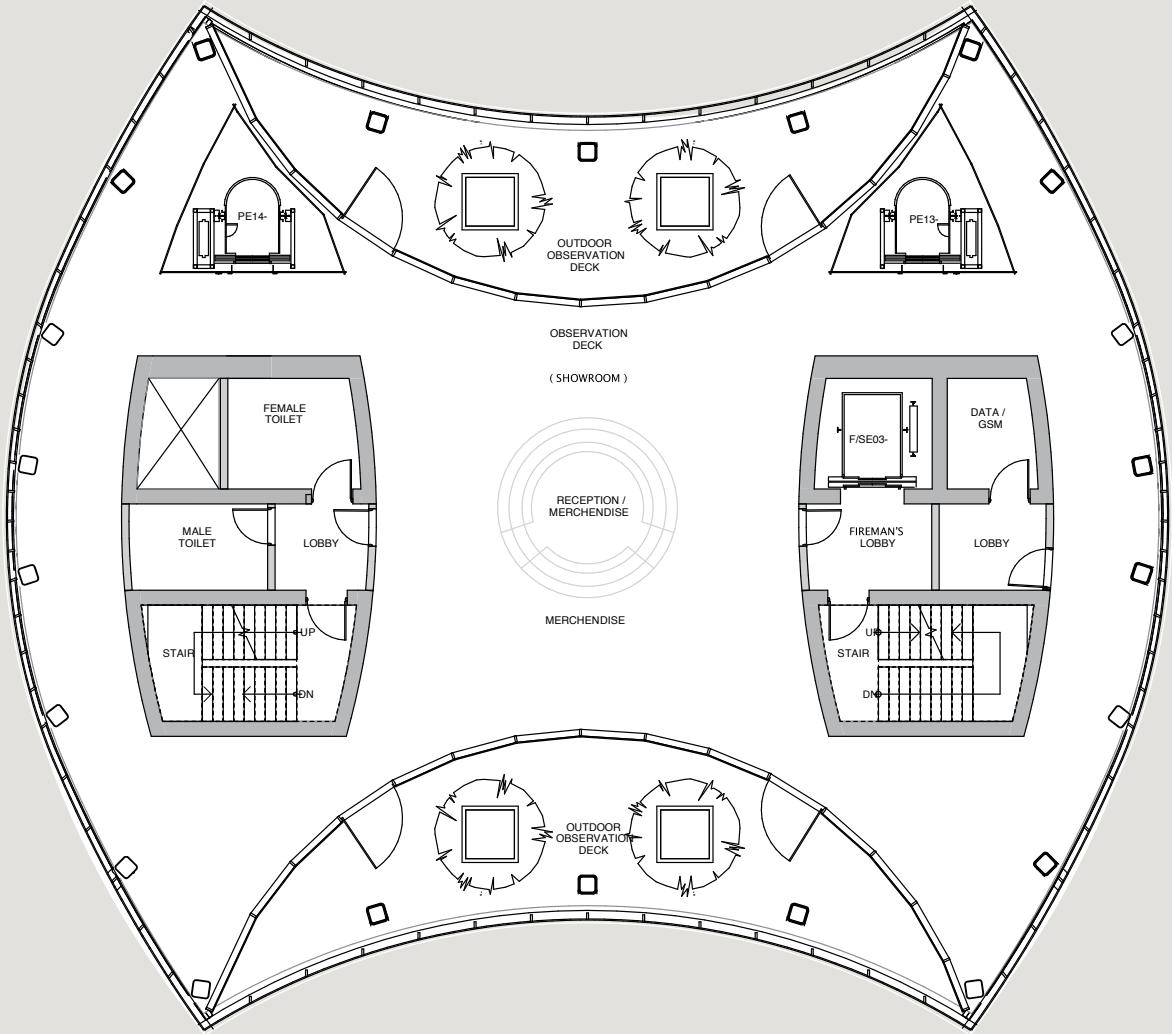

DUBAI MARINA VIEW



LEVEL 77

TFG Real Estate LLC on behalf of the Seller confirms that the information contained in this brochure or presentation is accurate at the time of purchase agreement entered into by the Seller and the Purchaser or the finished development. It should be noted that the (i) final design and I herein without any prior written notice and/or intimation.



res no liability of any nature whatsoever, should the building or any unit therein differ in any way from that illustrated herein or in the sale and to formal approval from the concerned authorities and; (ii) TFG Real Estate LLC reserves the right to change the benefits and offers specified