



P.O. Box 17777 | Dubai | United Arab Emirates
Tel: +971 4 390 3333 | Fax: +971 4 390 3314
nakheel.com | jumeirahparkhomes.ae





ABOUT DUBAI



Dubai, one of seven emirates that make up the United Arab Emirates, is a cosmopolitan city combining innovation and a modern lifestyle with traditional Arabian values.

The multicultural city of Dubai is strategically located at the gateway between East and West. It has rapidly become one of the world's most sought-after destinations for business, living and tourism.

Dubai is home to some of the world's most breathtaking and ambitious developments, including the iconic Palm Jumeirah, which has helped position Dubai as an attractive location for investment.

With a variety of residential options, world-class shopping and entertainment as well as excellent facilities and infrastructure, Dubai offers residents an unrivalled quality of life.



JUMEIRAH PARK



Welcome to Jumeirah Park, one of Dubai's most sought-after and well-established neighbourhoods, with verdant parks and communal green spaces.

Discover an unparalleled lifestyle in a high-end community with easy access to schools, hospitals and a range of neighbourhood amenities. Popular leisure and entertainment attractions, like shopping malls, fitness centres, restaurants and amusement parks are also a short drive away.

Jumeirah Park offers seamless connectivity to the upcoming Expo 2020 site and Al Maktoum International Airport.





JUMEIRAH PARK HOMES



Designed for the modern family, Jumeirah Park Homes is an exclusive collection of 147 luxurious four-bedroom residences, nestled among parks.

Starting at 3,807 square feet, each spacious home comes with its own private pool and garden, an open-plan kitchen, dining and living area as well as a double-garage and rooftop entertainment area, all with high-quality fixtures and fittings throughout. Floor-to-ceiling windows provide an abundance of natural light.

Home features:

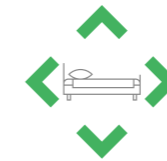

Four bedrooms
+
maid's room

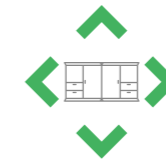

Built-in
wardrobes



Two walk-in
closets



Covered parking
for two cars



Private
garden



Private
swimming pool



Spacious
balconies



Large rooftop
entertainment space





LUXURY LIVING

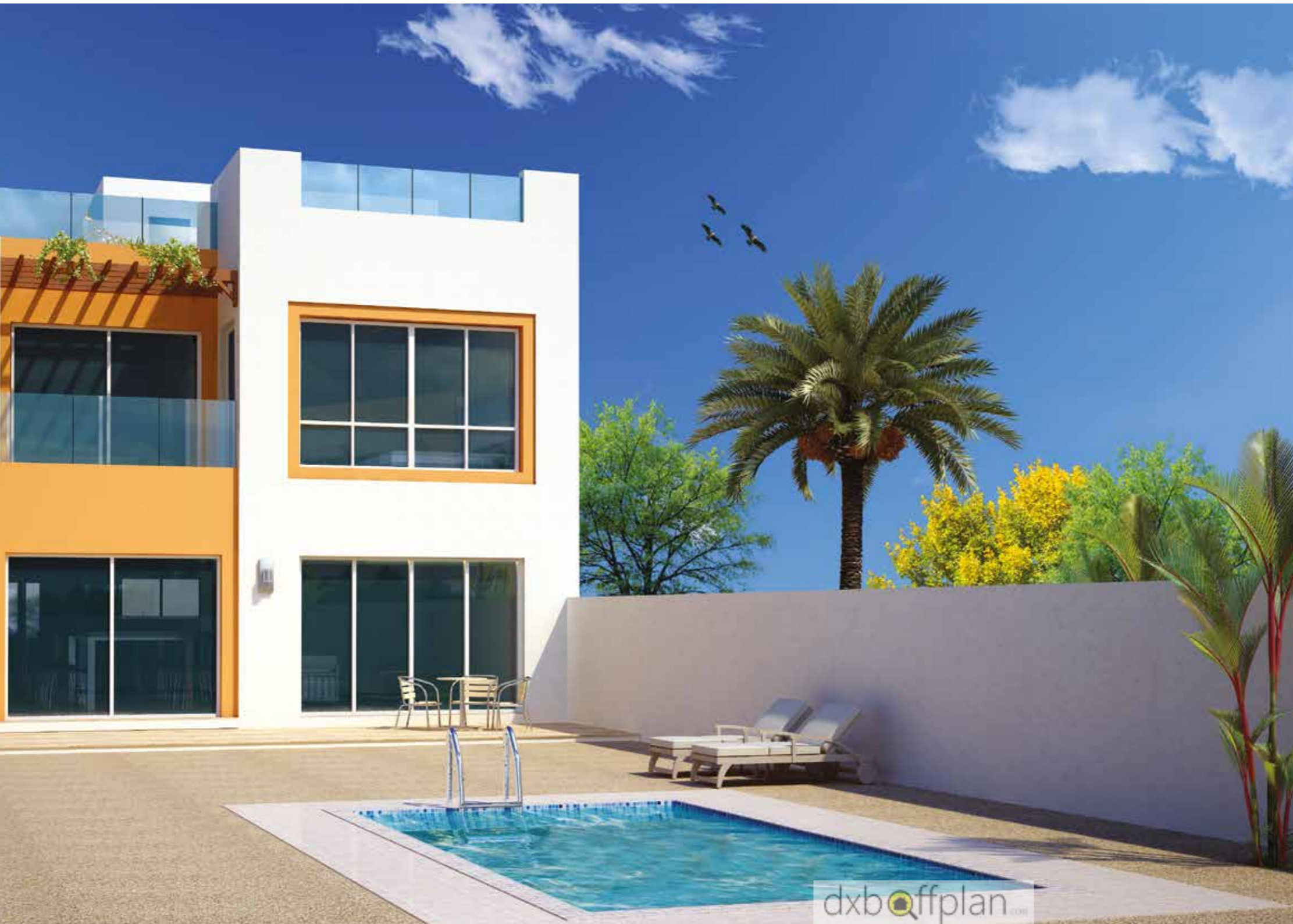

Stay at Jumeirah Park Homes and enjoy your own private **6m X 3m** swimming pool and spacious **19.5m X 8.75m** garden.

Unwind with a swim after a long day, relax with a book or savour special moments with loved ones in a tranquil and comfortable setting.

Enjoy intimate family gatherings indoors or entertain guests on the roof terrace with sweeping views of the neighbourhood.



Large or spacious private garden
19.5m X 8.75m



Private swimming pool
6m X 3m



Large rooftop entertainment space





SPACIOUS INTERIORS



The luxurious residences offer spacious interiors and multifunctional spaces. The use of clean lines and minimal details reflects elegant simplicity.

High-quality fittings have been carefully selected to create tasteful interiors. Generous living areas flow seamlessly into the expansive outdoor entertaining areas.





FLOOR PLAN A

FIRST FLOOR



ROOF TERRACE



GARDEN



GROUND FLOOR

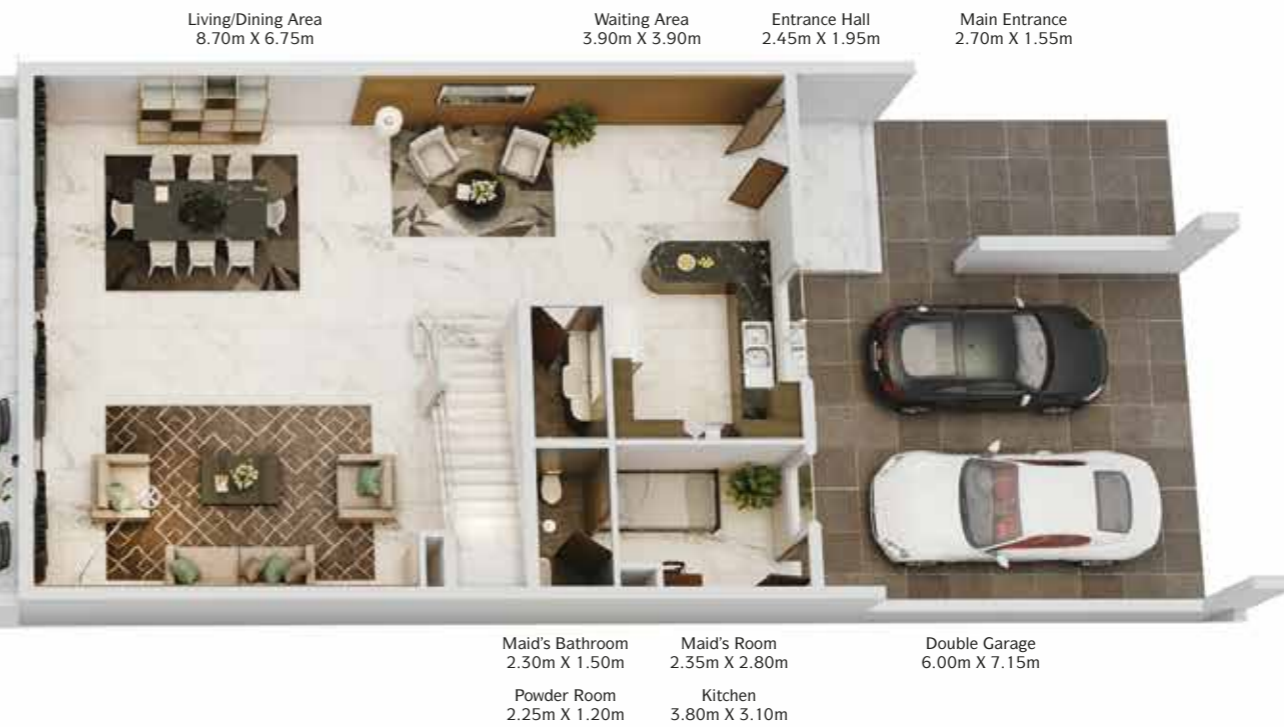

Jumeirah Park Homes 4-Bedroom Residences

Built Up Area (Sq.ft.)	Balcony & Terrace (Sq.ft.)	Gross Floor Area (Sq.ft.)
3,461.16	375.66	3,836.83

The developer reserves the right to make revisions. All the measurements and drawings are approximate. All information is subject to change without notice. Do not scale drawings. Artistic renderings, landscaping and images are for illustrative purposes only and are subject to change without notice. November 2018.



FLOOR PLAN B

FIRST FLOOR



ROOF TERRACE



GARDEN



GROUND FLOOR

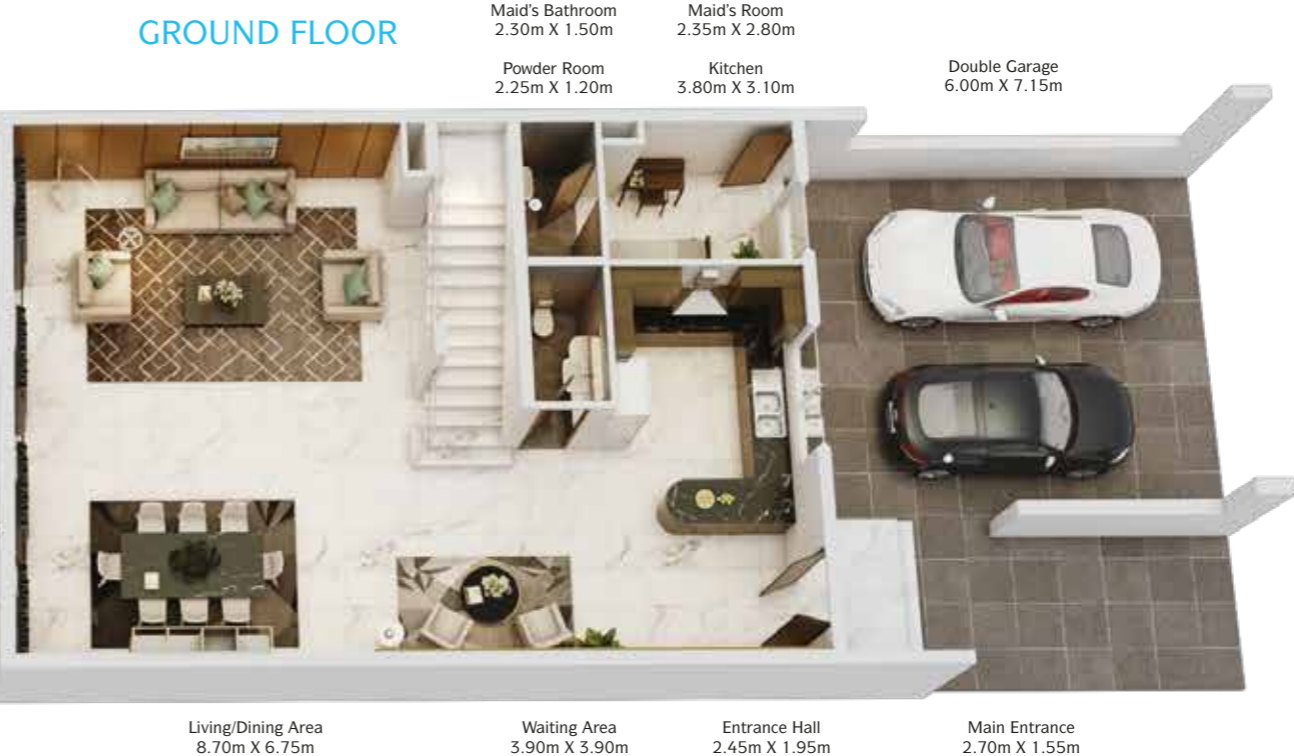

Jumeirah Park Homes 4-Bedroom Residences

Built Up Area (Sq.ft.)	Balcony & Terrace (Sq.ft.)	Gross Floor Area (Sq.ft.)
3,461.16	375.66	3,836.83

The developer reserves the right to make revisions. All the measurements and drawings are approximate. All information is subject to change without notice. Do not scale drawings. Artistic renderings, landscaping and images are for illustrative purposes only and are subject to change without notice. November 2018.



SUPERIOR AMENITIES



dxboffplan

Clubhouse

Residents of Jumeirah Park Homes can enjoy a healthy and active lifestyle through access to a range of community amenities, including an upcoming clubhouse, sports and leisure complex.

The clubhouse boasts an Olympic-size swimming pool, one of Dubai's biggest gyms as well as a spa. The complex also offers children's facilities, including a nursery and kids' pool. A supermarket, medical clinic, beauty outlets and everyday convenience stores provide a range of retail amenities.

Jumeirah Park Pavilion, the lively and established community centre nearby, offers a supermarket, shops, restaurants, cafés and beauty outlets, all under one roof.



Jumeirah Park Pavilion



Community Centre



A WELL-CONNECTED ADDRESS

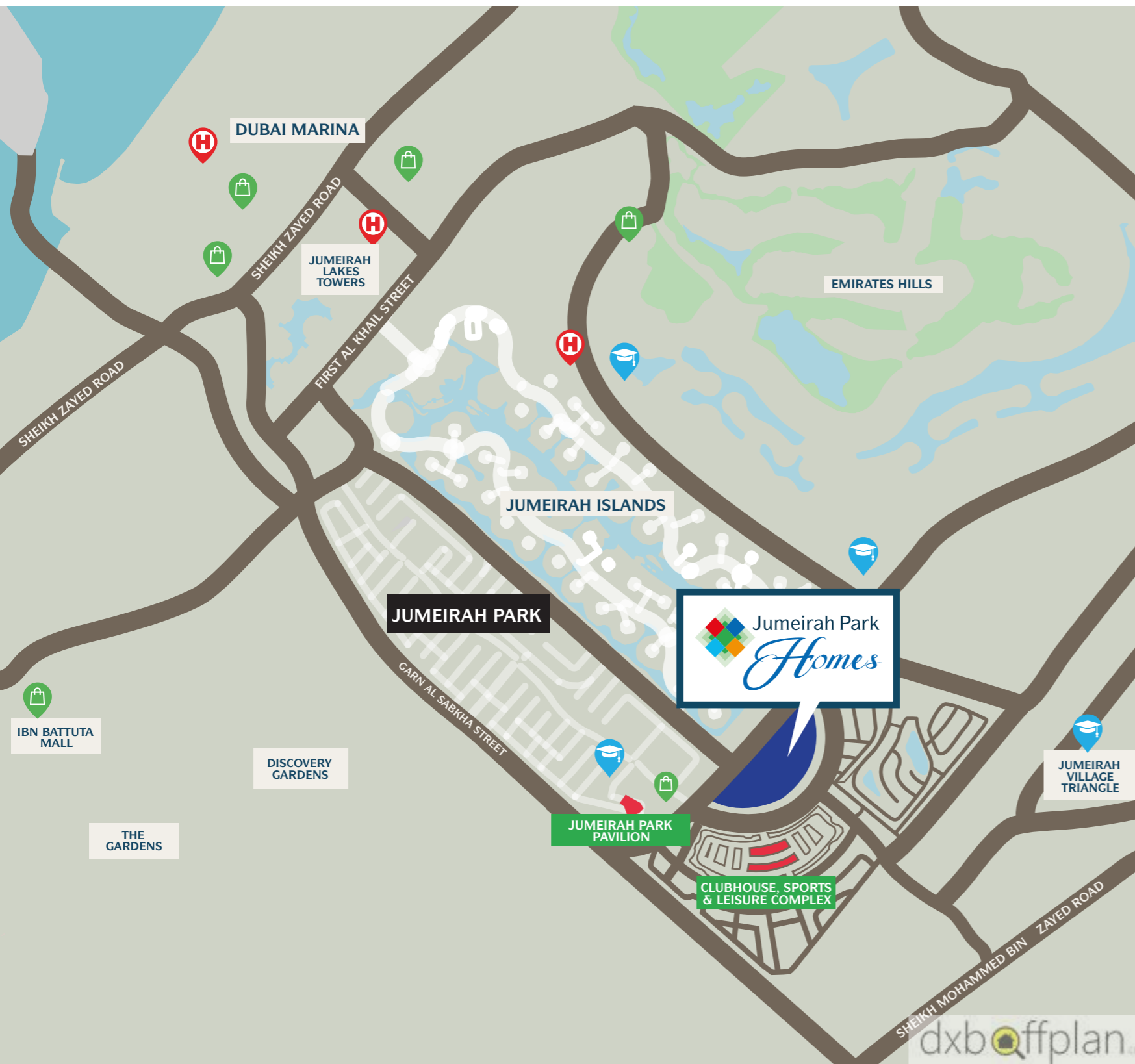

Jumeirah Park Homes is located in close proximity to schools and is well-connected to major roads and business hubs:

- 35 minutes from Dubai International Airport*
- 35 minutes from the Expo 2020 site*
- 35 minutes from Al Maktoum International Airport*
- 20 minutes from the public beach*
- 15 minutes from Dubai Media City and Dubai Internet City*
- Direct access to two major highways via Garn Al Sabkha Street – Sheikh Zayed Road and Sheikh Mohamed bin Zayed Road
- Located close to Jumeirah Islands Pavilion, Jumeirah Lakes Towers, Ibn Battuta Mall and Al Khail Avenue.

*Approximate distances





MASTER PLAN

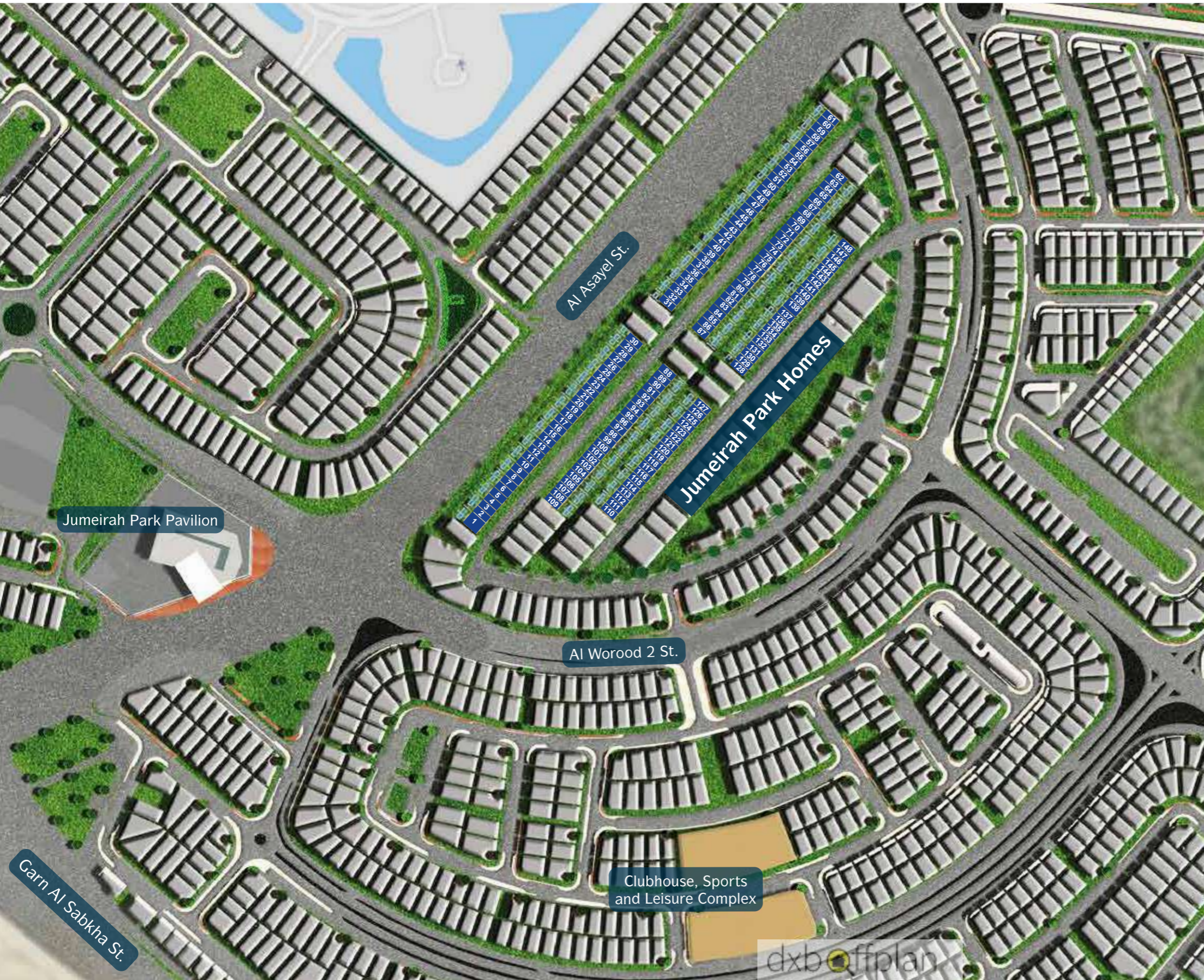

With 147 residences in the heart of one of Dubai's most desirable communities, Jumeirah Park Homes offers residents a convenient location that is within walking distance to a clubhouse, sports and leisure complex, Jumeirah Park Pavilion and other amenities.



NAKHEEL THE MASTER DEVELOPER



Nakheel is a world-leading developer and a major contributor to realising the vision of Dubai for the 21st century: to create a world-class destination for living, business and tourism. Nakheel continues to deliver and enhance an iconic portfolio of innovative landmark projects in Dubai across the residential, retail, hospitality and leisure sectors.

Our master developments include Palm Jumeirah, The World, Deira Islands, Jumeirah Islands, Jumeirah Village, Jumeirah Park, Jumeirah Heights, The Gardens, Discovery Gardens, Al Furjan, Warsan Village, Dragon City, International City, Jebel Ali Gardens and Nad Al Sheba. Together, these span more than 15,000 hectares and currently provide homes for over 270,000 people. Nakheel has around 25,000 residential units under construction or in the pipeline.

Nakheel's retail arm, Nakheel Malls, is the Middle East's largest retail developer, with 17.5 million square feet of leasable space across 19 projects, including large-scale destination malls and souks, F&B destinations and community shopping centres. Assets include the world-famous Ibn Battuta Mall and Dragon Mart, both of which continue to undergo major expansions.

Upcoming projects include Nakheel Mall on Palm Jumeirah; Deira Mall at Deira Islands; Al Khail Avenue at Jumeirah Village and more. Our growing hospitality project portfolio comprises 18 hotels and serviced apartment developments with over 6,600 rooms and hotel apartments between them at various locations in Dubai, including Palm Jumeirah, Deira Islands, Ibn Battuta Mall, Jumeirah Village and Dragon City. Two are currently open and operational, with the rest at various stages of construction and development.